



AUSTRALIAN VALVE AND ENGINEERING

PTY. LTD. • A.C.N. 007 400 759 • A.B.N. 98 007 400 759

VALVE AND FITTING MANUFACTURE
GENERAL ENGINEERING • VALVE RECONDITIONING

19 MARTIN DRIVE, BALLARAT
P.O. BOX 1755, BALLARAT MAIL CENTRE. 3354.
PHONE (03) 5336 2113 • FAX (03) 5336 2115
EMAIL avevalves@bigpond.com
WEBSITE www.aussievalve.com.au



JOHN VALVES

The Valve People
Australian made :: Australian owned

Australian Agents for
IMI Bailey Birkett Ltd

BALL FLOAT TYPE STEAM TRAP

■ BFT16S / BFT16F (BALL FLOAT TYPE STEAM TRAP)

- More various applications than disc type steam trap.
- Suitable for big volume condensate discharge application.
- Ball material of stainless steel designed for resisting water-hammer.
- Easy maintenance & checking when installed owing to simple construction.

● SPECIFICATIONS

Working Pressure	Max. 4.5, 10, 14 kgf/cm ²
	Min. 0.35 kgf/cm ²
Working Temperature	Max. 220 °C
Connection	BFT16S : Screwed
	BFT16F : Flanged
Materials	Body : Ductile Iron
	Trim : Stainless Steel

● DIMENSIONS

MODEL	SIZE	d	L	H1	H	Connection
BFT16S	15	1/2"	120	120	155	Screwed
	20	3/4"	120	120	155	
	25	1"	120	185	190	
	32	1 1/4"	270	240	295	
	40	1 1/2"	270	240	295	
BFT16F	15	15	200	110	170	Flanged
	20	20	200	110	170	
	25	25	215	195	220	
	32	32	320	240	295	
	40	40	320	240	295	
50	50	360	260	310		

FLOW RATE CAPACITY IN Kg/h

MODEL	SIZE	DIFFERENTIAL PRESSURE (bar)													
		0.5	1	1.5	2	3	4.5	6	7	8	9	10	12	14	
BFT16 - 4.5	1/2" - 3/4"	200	280	320	360	400	495								
BFT16 - 10	1/2" - 3/4"	110	140	175	190	230	280	300	330	350	390	405			
BFT16 - 14	1/2" - 3/4"	70	100	120	140	155	190	210	220	225	230	260	280	300	

FLOW RATE CAPACITY IN Kg/h

MODEL	SIZE	DIFFERENTIAL PRESSURE (bar)												
		0.5	1	1.5	2	3	4.5	6	7	8	9	10	12	14
BFT16 - 4.5	1"	900	1250	1450	1700	2010	2400							
BFT16 - 10	1"	390	550	675	790	900	1000	1200	1300	1400	1500	1590		
BFT16 - 14	1"	250	350	430	500	590	680	800	850	900	950	1000	1000	1150

FLOW RATE CAPACITY IN Kg/h

MODEL	SIZE	DIFFERENTIAL PRESSURE (bar)									
		0.5	1	1.5	2	4.5	7	10	12	14	
BFT16 - 4.5	1 1/2"	2400	3400	3900	4500	7300					
BFT16 - 10	1 1/2"	1500	2000	2600	3000	4000	5400	6200			
BFT16 - 14	1 1/2"	950	1300	1600	1800	2600	3250	3900	4210	4950	

FLOW RATE CAPACITY IN Kg/h

MODEL	SIZE	DIFFERENTIAL PRESSURE (bar)								
		0.5	1	1.5	2	4.5	7	10	12	14
BFT16 - 4.5	2"	7550	11000	14000	15500	20500				
BFT16 - 10	2"	3900	5000	6100	7100	10000	13750	16000		
BFT16 - 14	2"	1900	2700	3100	3600	5000	6900	8100	9000	9800

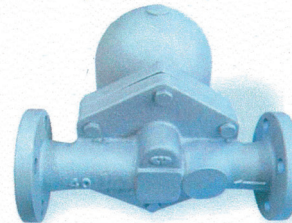

H1

H1

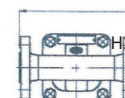
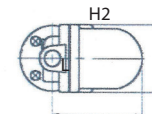
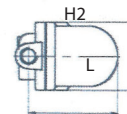

H1

H1

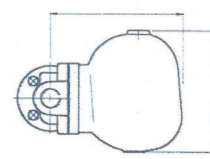
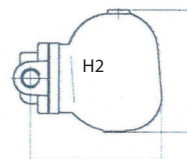

H2